

# LAKE SURVEY MAP

WASHBURN COUNTY FOREST

B.M. 'X' D.N.R. 1613 - A Bronze cap set in concrete post 78' N. of lake and 36' W. of centerline of access road on N. side of lake  
Assumed elevation 100.00'  
Water level 91.63'

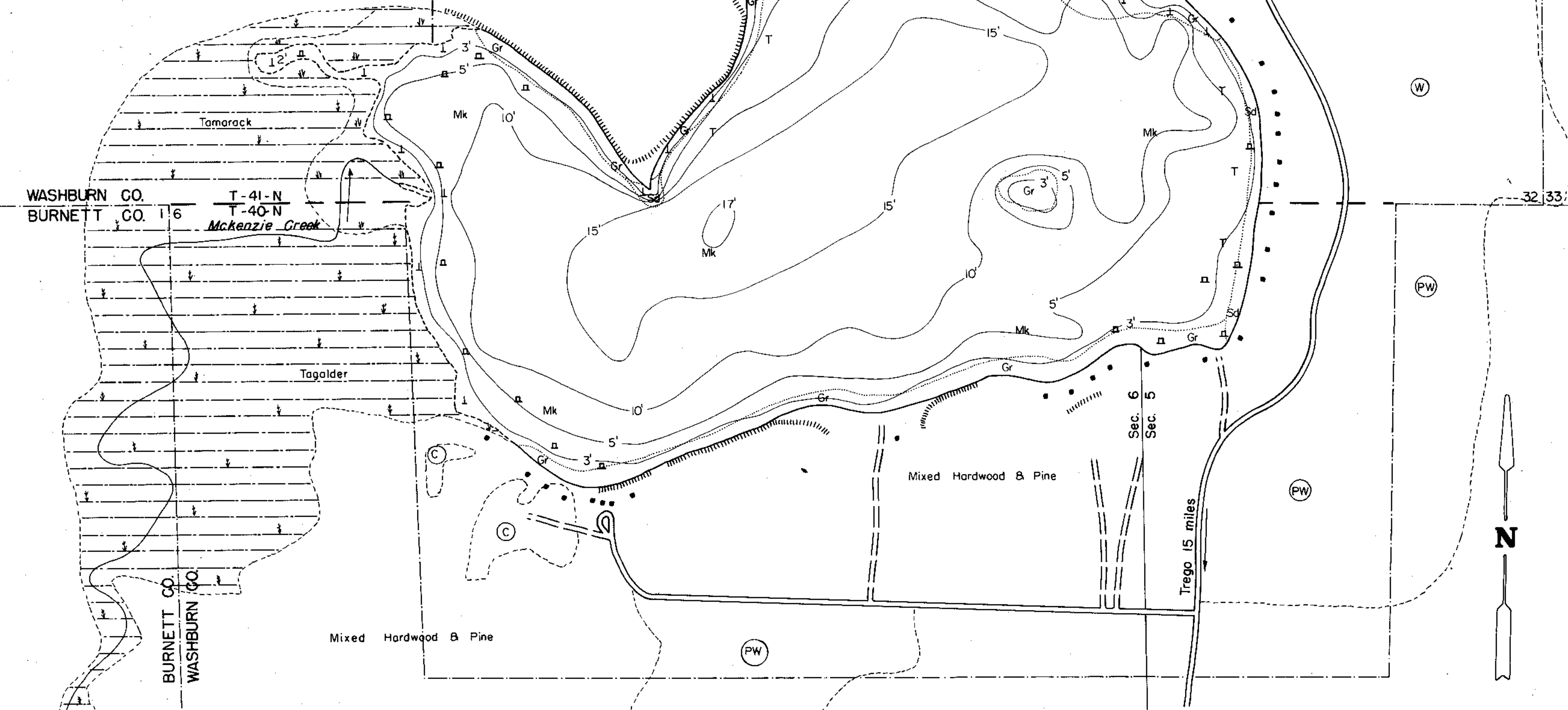
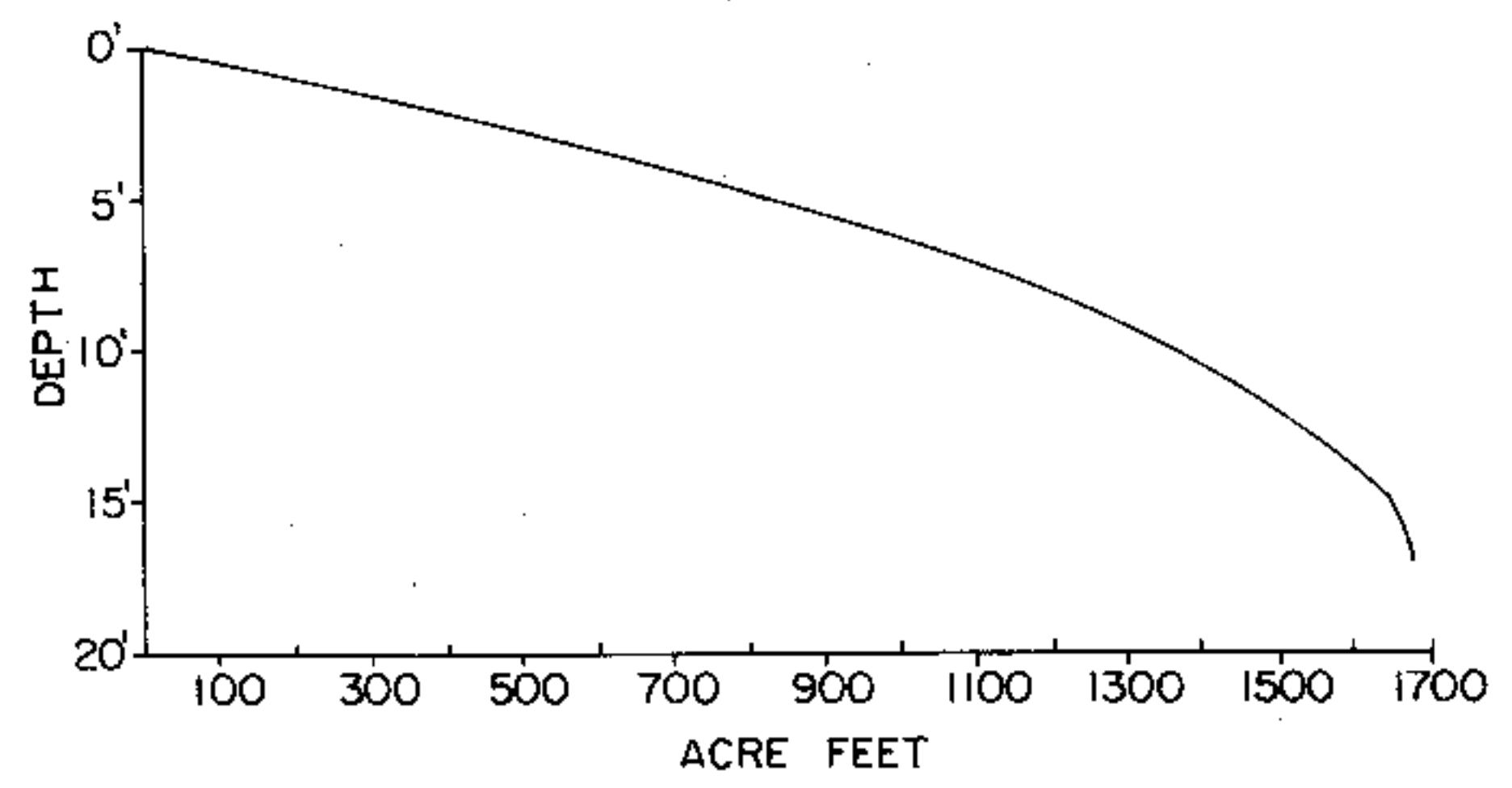

EQUIPMENT RECORDING SONAR MAPPED JUNE 1971  
MONTH YEAR

- TOPOGRAPHIC SYMBOLS**
- (B) Brush
  - (PW) Partially wooded
  - (W) Wooded
  - (C) Cleared
  - (P) Pastured
  - (A) Agricultural
  - B.M. Bench Mark
  - Dwelling
  - Resort
  - Camp
  - (|||||) Steep slope
  - (---) Indefinite shoreline
  - (~) Marsh
  - (o) Spring
  - (---) Intermittent stream
  - (---) Permanent inlet
  - (---) Permanent outlet
  - (---) Dam
  - (---) D.N.R. State owned land

- LAKE BOTTOM SYMBOLS**
- P. Peat
  - Mk. Muck
  - C. Clay
  - M. Marl
  - Sd. Sand
  - St. Silt
  - Gr. Gravel
  - R. Rubble
  - Br. Bedrock
  - B Boulders
  - o Stumps & Snags
  - ⊙ Rock danger to navigation
  - T Submergent vegetation
  - ⊥ Emergent vegetation
  - ⊥ Floating vegetation
  - ⊥ Brush shelters



◆ Access    ◆ Access with Parking    ◆ Boat Livery

Drawn by: C. Holt  
Field work by: C. Busch, G. Lund, L. Sather

SPECIES OF FISH	Abundance		
	Abundant	Common	Present
Muskie			
N. Pike		X	
Walleye			
L.M. Bass		X	
S.M. Bass			
Panfish	X		
Trout			

WATER AREA 185.4 ACRES  
UNDER 3 FT. 11 %  
OVER 20 FT. 0 %  
MAX. DEPTH 17 FEET.  
TOTAL ALK. 68 P.P.M.  
VOLUME 1675 ACRE FT.  
SHORELINE 3.12 MILES



Source: Wisconsin Department of Natural Resources 608-266-2621  
Lower McKenzie Lake - Washburn County, Wisconsin DNR Lake Map  
Date – Jun 1971 - Historical Lake Map - Not for Navigation  
A Public Document - Please Identify the Source when using it.